



Kestrel 5700

Easy Mode Start Guide

1

Insert the **included batteries** in your Kestrel and then attach the lanyard (*included*).



Battery Door Latch

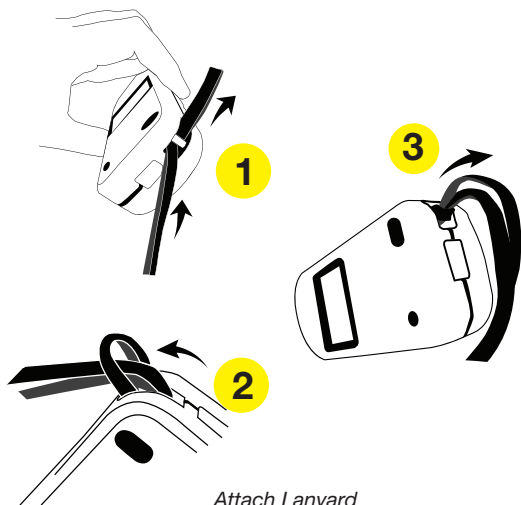

Attach Lanyard

2

Download **Kestrel LiNK Ballistics** app to your mobile device.

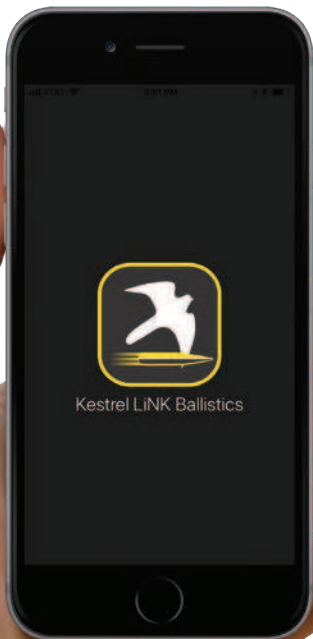

Note: Make sure to choose **LiNK Ballistics**, not **LiNK Weather**, when selecting the app.

3

Open the app and connect to your Kestrel.

Note: Bluetooth icon on single target and target card screens turns green (🟢) when Kestrel is paired to mobile device.

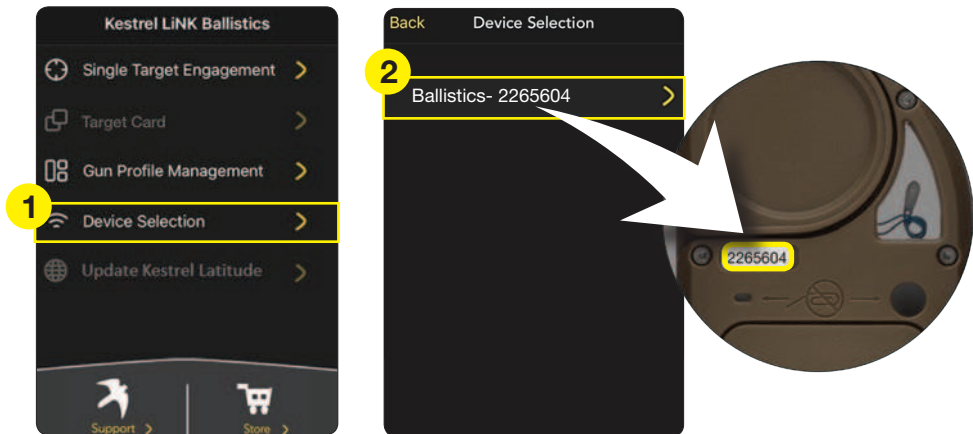

Trouble Shooting: Make sure Bluetooth is turned on in your mobile device. Make sure Bluetooth is turned on in your Kestrel and set Connect to PC/Mobile in the Bluetooth Sub Menu. Your Kestrel will not appear on the Bluetooth connection menu in your mobile device. Use the Device Selection button in the app to connect.

4

Press the button to update the latitude in your Kestrel.

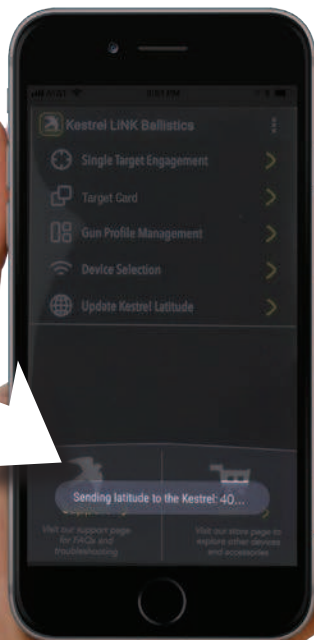
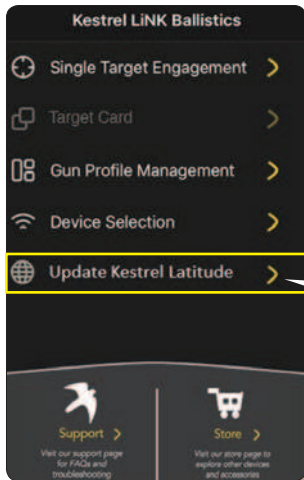

5

Input your gun & bullet information in the app then save it as a gun profile.

Hint: The Bullet Library contains the needed inputs for hundreds of common long range bullets. If you don't know one of the inputs for your gun, tap the parameter name for additional guidance

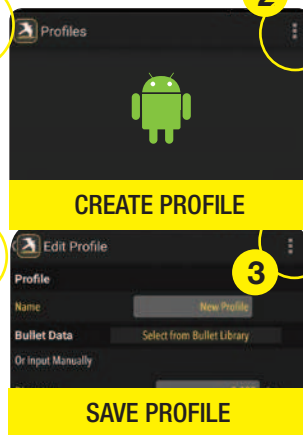
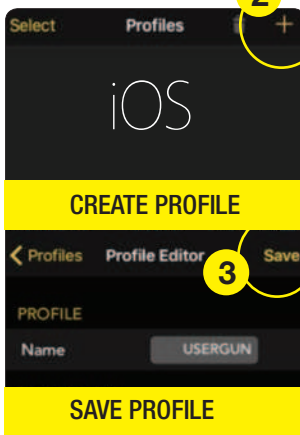
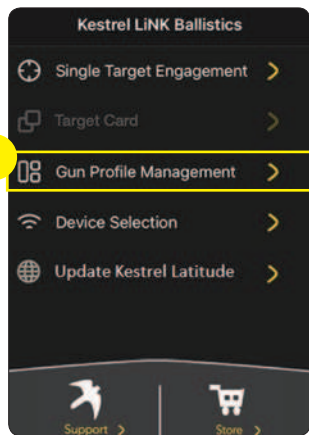

Note: On some android devices, use the  button.

Note: Building gun profiles in the app is the easiest method. Gun profiles can also be created directly in the Kestrel in Ballistics Mode.

6

Send your gun profile from the app to the Kestrel.

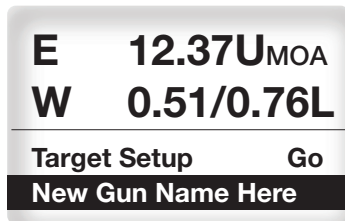

In the Kestrel, scroll down to make sure the gun profile transferred correctly.

Note: To edit gun info or to create a new gun profile, repeat steps 5 & 6

KESTREL BUTTONS

◀▼▶▲ Scroll/Toggle ← Select ⚙ Exit ⏻ On/Off

7

On startup, the Kestrel will open to the Solution Screen. On the solution screen, scroll down to Compass Cal and press select. Follow the on screen instructions.

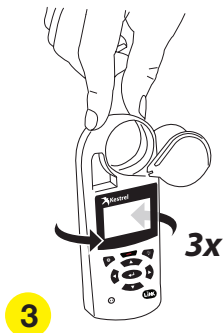
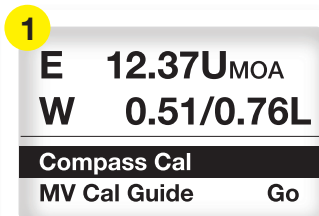

Trouble Shooting:

If compass calibration is failing, try standing the Kestrel on a flat surface (non-metallic) while rotating. Make sure the Kestrel is in a vertical position before pressing start and remains vertical throughout the calibration turns.

8

On the Kestrel's solution screen scroll to Target Setup, press select and follow on screen instructions. Repeat this step each time you shoot at a new target in a different direction or if the wind or temperature have changed.



Hint:

DOF=Direction of fire

WD= Wind Direction

WS1= Average wind speed

WS2=Peak wind speed

9

On the Kestrels solution screen, scroll to Target Range and press left or right to dial to the correct target distance. Next dial the solution in your scope's turrets or hold-over using your scope's reticle and shoot your target!



Hint:

E=Elevation correction

W=Average/Peak wind windage correction

Hint: *If unsure of your Muzzle Velocity, or if the solution provided by the Kestrel is not matching your point of aim, use the MV Cal Guide feature at the bottom of the Kestrel's Easy Mode menu to improve accuracy.*

KESTREL BUTTONS



Scroll/Toggle



Select



Exit



On/Off

10

To exit out of Easy mode and access your 5700's full features, press the Exit button and change Mode to from Easy to Ballistics.



Full Ballistics Mode features include

- » *Build and Manage gun profiles in the Kestrel*
- » *High angle shot correction*
- » *Ballistics data menu*
- » *Target Range Estimator*
- » *Moving Target correction*
- » *And more...*



By

NIELSEN-KELLERMAN

21 Creek Circle

Boothwyn, PA 19061

**Kestrel® Weather and Environmental
Meters are designed and manufactured
in the USA**

For additional help, support videos
and a full manual visit

**www.kestrelballistics.com/help
or contact us at (610) 447-1555**